

Uniclass	EPIC
L411:P43	D11:X421
Cl/SfB	
(31.5)	Xh4

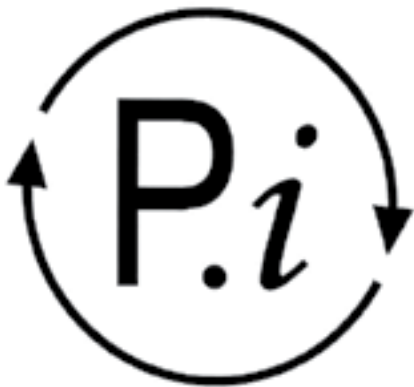

comar7P.i TSD

Comar 7P.i Tilt & Slide Door System



complementing architecture

design

Comar 7P.i TS Showing Double Door Meeting Stile

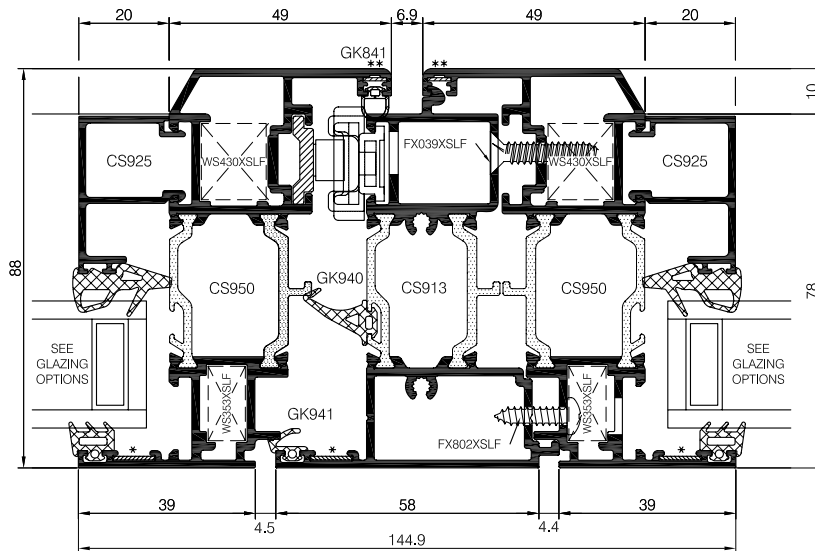

Comar 7P.i Tilt & Slide Door

The Comar 7P.i Tilt & Slide Door (TSD) System is the latest innovation to be included in the Comar 7P.i High Performance Range. The main advantage of the Comar 7P.i Tilt/Slide system is you have all the advantages of a sliding door system with the addition of a tilt mode to provide ventilation. It provides a unique solution where other door types would cause an obstruction internally or externally, maximising floor space and clear openings.

Comar 7P.i TSD suites seamlessly into Comar 9P.i framing, like all Comar 7P.i products value engineering is achieved by the doors hanging directly from the frame; reducing sight-line, aluminium content and with this larger glass to frame ratio, lower U-values. Comar 7P.i is a semi-unitised system with fast-track installation through modular

elements which can be coupled together and adjusted to suit site tolerances.

Security concerns are alleviated with the fact that the Comar 7P.i TSD exceeded the requirements of PAS 24:2012 and Comar Architectural Aluminium Systems is a Secured by Design License Holder. On test Comar 7P.i TSD for BS 6375-1 the British Standard Classification for Weather-tightness, achieving Class 4:600Pa Air, 750Pa Water and 2000Pa Wind Resistance.

Function is achieved by designing into this elegant profile suite the very latest, durable tilt/slide gear. Tested to over 200,000 cycles the slide and tilt gear are infinitely adjustable to ensure for long term operation.

comar7P.i TS

perform

Combinations & Construction

The Comar 7Pi TSD can be a 2 pane fixed and sliding leaf or a 4 pane bi-part system. To create curved facades Comar 7Pi offers faceted profiles within the framing. The Comar 7Pi is semi-unitised system which can be manufactured off-site, glazed if required and then the units are coupled together with the doors hanging directly from the frame.

Locking & Tilt Mode

A six-point high security multipoint-locking system securely locks the door-sets with a combination of shoot-bolt and mushroom heads.

The same high security locking system, when operated with the handle seamlessly puts the door-set into tilt mode which allows secure ventilation.

Glazing Options

As part of the Comar 7Pi system, all glazing types and thicknesses can be accommodated with a range of glazing gaskets, from panels to acoustic triple glazed units, up to a width of 62mm.

Weather Performance & Security

Summary of testing and classification	Test standard	Classification standard	Result
Air permeability	BS EN 1026: 2000	BS EN 12207: 2000	600Pa (Class 4)
Watertightness	BS EN 1027: 2000	BS EN 12208: 2000	750Pa (Class E750)
Wind resistance	BS EN 12211: 2000	BS EN 12210: 2000	2000Pa (Class A5)
Exposure category		BS 6375: part 1: 2009	2000Pa
BS 7950: 1997 - tested to clauses A.4, A.5, A.6 and A.7			Pass



Comar 7P.i TSD Showing Fixed and Opening Door Leaf

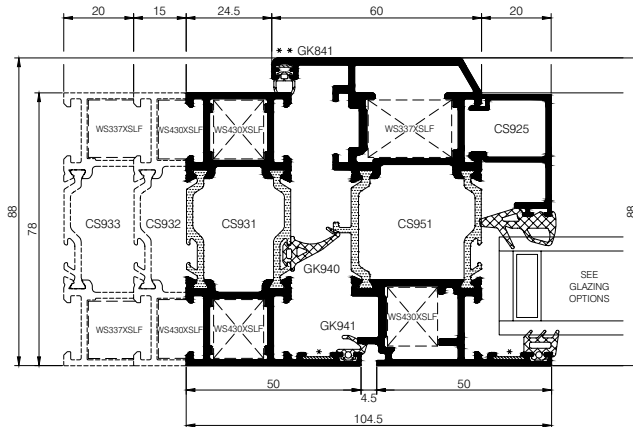

Comar 7P.i TSD Showing Optional Head Details

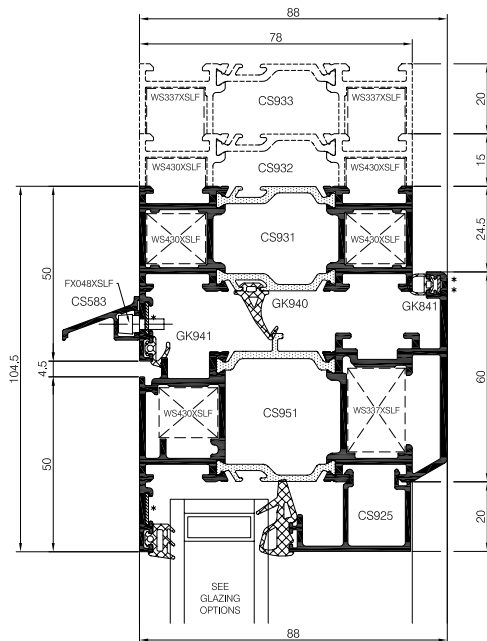

Comar 7P.i TSD Showing Sill Detail and Sliding Gear

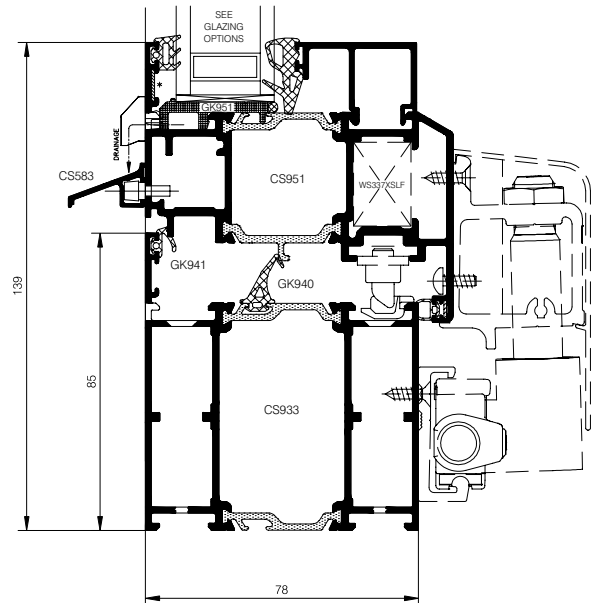

* Denotes WS015XSLF Chevron ** Denotes WS515XSLF Chevron

The Parkside Group Ltd

The Willow Centre
17 Willow Lane, Mitcham
Surrey CR4 4NX

Tel: 0208 685 9685
Fax: 0208 646 5096
Email: projects@parksidegroup.co.uk
Web: www.comar-alu.co.uk

Technical Back-Up

An experienced Sales Team covers the UK while the Technical Department offers an unsurpassed design and installation advice service to designers, specifiers and fabricators; Simply call: 0208 685 9685

For More Information

To find out more about this or any other Comar Architectural Aluminium System, or to obtain your personal copies of the Comar Technical Manuals call: 0208 685 9685 or fax on: 0208 646 5096